

John Fields Claim  
in Crawford County.

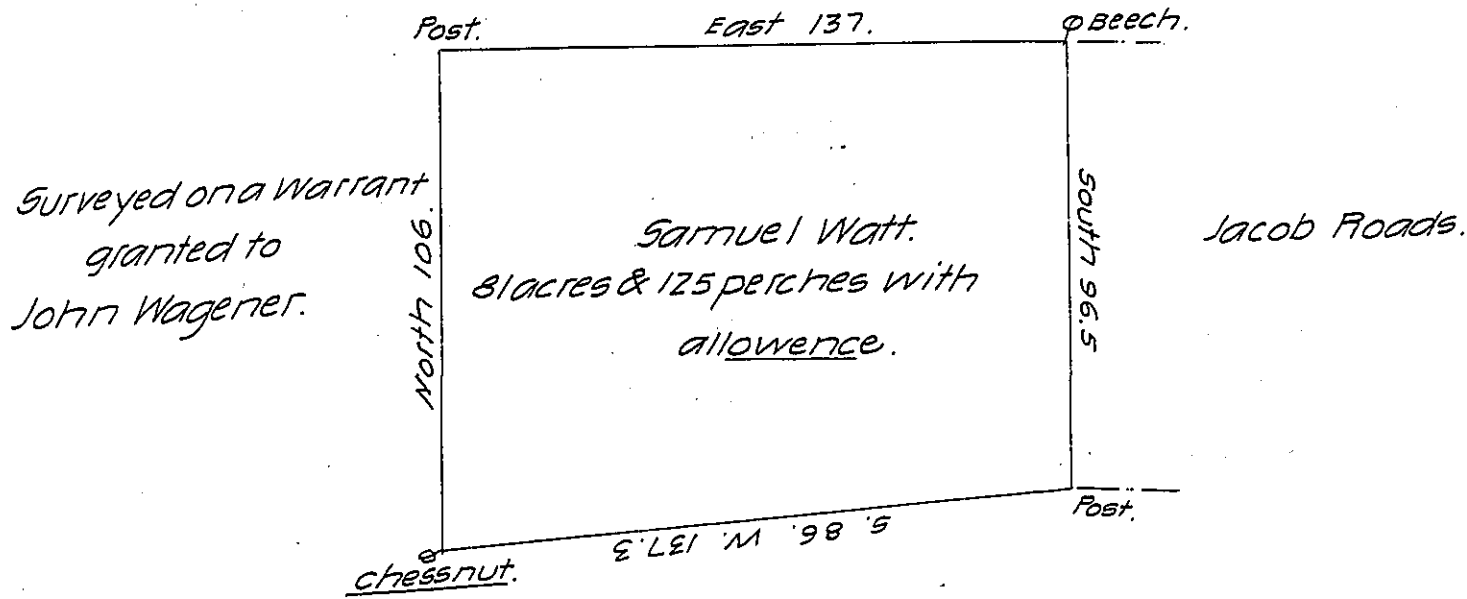

Jones Fell.

Situate in Selam Township Mercer County adjoining the Line di-  
viding Mercer from Crawford County containing eighty one acres &  
one hundred and twenty five perches with allowance of six per  
cent for roads & ca. Surveyed December 17th 1834. In pursuence  
of an improvement and actual settlement and Residence on the  
same by and for Samuel Watt. The same not appearing from the  
Books & Records in my possession to have been heretofore appro-  
priated to any other person or purpose.

Surveyed by me

John Findley D. S.

To Jacob Spangler Esqr.

Surveyor General.

IN TESTIMONY that the above is a copy of the original remaining on file in  
the Department of Internal Affairs of Pennsylvania, made  
conformably to an Act of Assembly approved the 16th day of  
February, 1833, I have hereunto set my Hand and caused  
the Seal of said Department to be affixed at Harrisburg,  
this twenty third day of May 1907

*Henry Howell*  
Secretary of Internal Affairs.